

**MAIN LEVEL**  
Area: 2256 sq. ft.

1446 Bramwell Road  
West Vancouver, BC

Main Level: 2256 sq. ft.  
Upper Level: 1353 sq. ft.  
Lower Level: 2193 sq. ft.  
Total: 5802 sq. ft.

Other Areas: (not included in total)

Balconies: 466 sq. ft.  
Garage: 642 sq. ft.  
Garage: (low-level) 20 sq. ft.

3-CAR GARAGE  
29'6" x 18'10"

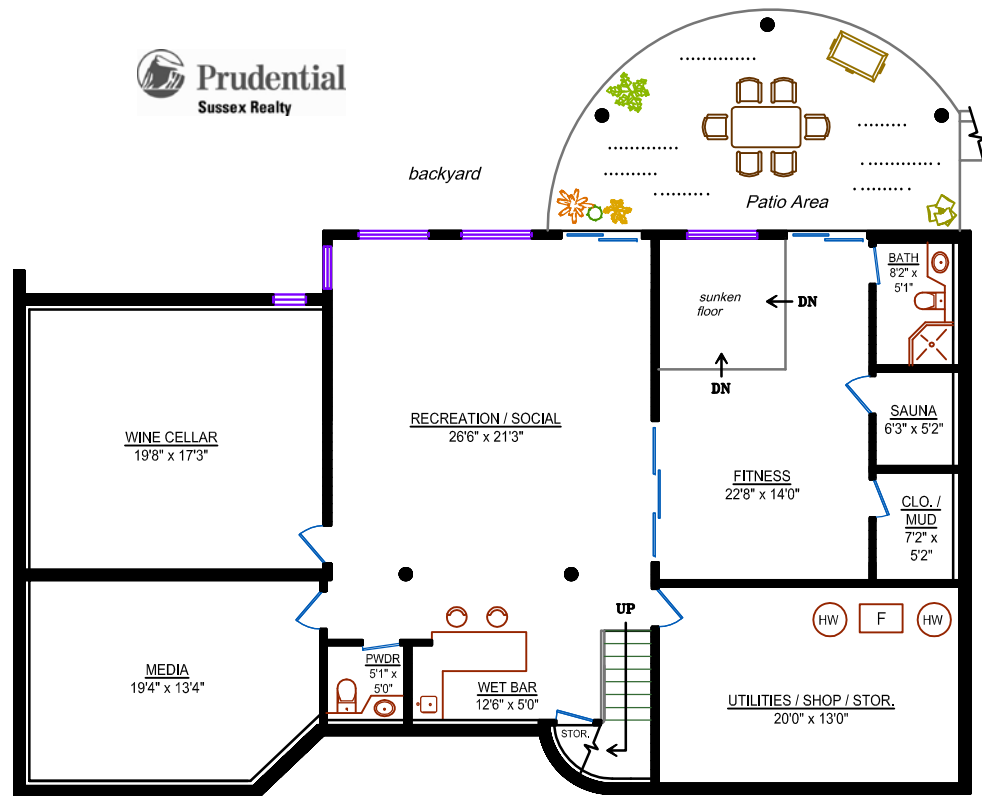
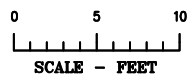

**LOWER LEVEL**  
Area: 2193 sq. ft.

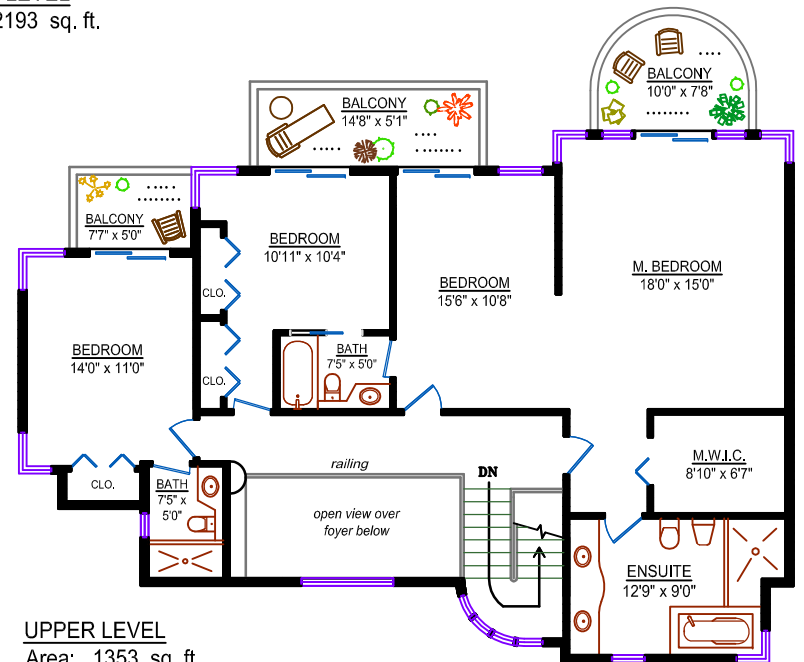

**UPPER LEVEL**  
Area: 1353 sq. ft.

**JASON SOPROVICH**

MARKETING VANCOUVER'S MOST ELEGANT HOMES AND LUXURY REAL ESTATE

604.817.8812

jason@jasonsoprovich.com

www.soprovich.com

Design Ideas 4u

604-862-5914  
\* room dimensions are approximate \*  
\* sq. ft. measurements are not guaranteed \*